



- 1 Cut 45-degree angle** at the head and side jamb joints on each side and temporarily fasten the top flap with a piece of tape. Cut the WRB a minimum of 1" to 1-1/4" away from the rough opening sides to expose the sheathing.



- 2 Measure the depth of the window frame**, but do not include the extension jamb if present. Add a 1/4", measure that total on to the buck's rough sill, and mark it with a pencil. This will show you where the interior edge of the flashing should be.



- 3 Apply corner guards** at sill and side jamb joints by using a 6" x 6" piece of flashing tape, cutting it into a "butterfly" shape and forming into the corners.

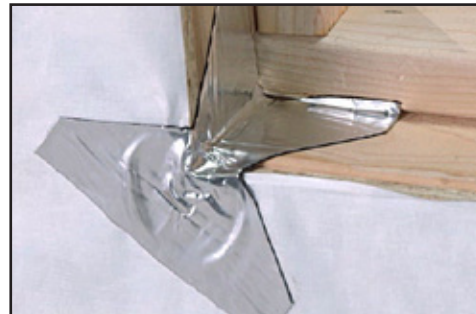

- 4 Place two corner guards** into the back rough opening on both sides making sure they extend past the back frame into the rough opening a minimum of 1".



- 5 Cut the sill flashing** to the width of the rough opening plus 12". Center the flashing tape on the exterior sill butting it to the exterior edge of the buck so that it extends up each side jamb 6".



Recessed Flanged Window

Quick Reference Guide
For the use of the Quad Window & Door System

- 6** Make relief cuts in the corners and then fold the flashing tape onto the apron. Use the J-roller to remove any air pockets.

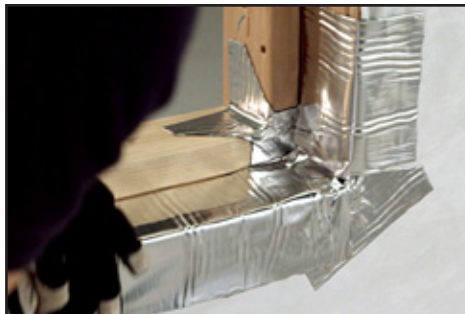

- 7** Cut the sill flashing to the width of the rough opening plus 12". Align the flashing tape with the pencil marks from step 2.

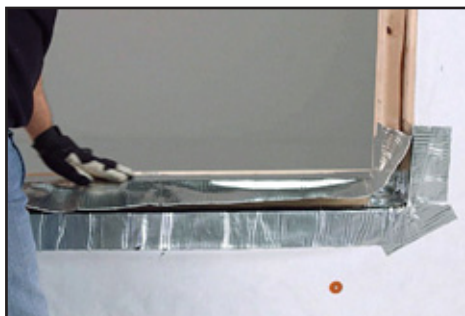

- 8** Make relief cuts in the corners and fold the back flashing over the primary sill flashing, with a minimum 2" overlap. Use the J-roller to remove any air pockets.



- 9** Set your U-shaped plastic PVC shims on the sill. Shims must recess a 1/4" from the interior window frame. Then set a level on top, bridging the shims. Once they are level, seal the shims onto the sill using OSI® QUAD® Max.



- 10** Apply a continuous 3/8" rounded bead of OSI® QUAD® Max to the head and side buck edges.



- 11** Apply a **discontinuous bead** along the bottom buck edge leaving a minimum of a 2" gap at each corner and every 6" to 8".



- 12** **Center the window** in the rough opening on the shims and check for level, plumb, and square.



- 13** **Install the window** using all manufacturer's installation instructions and ensure the window operates properly. Tool any bulging sealant flat, so it doesn't interfere with future cladding installation.



- 14** **Remember** - some manufacturers may require you to install corner guards at the head and side jambs.



- 15** **Measure and cut the side jamb flashing.** Length = height of rough opening plus 2x flashing width minus 1".



- 16** Lay the first piece over the WRB making sure the side jamb flashing covers the exterior corner guards and sill flashing.



- 17** Make two relief cuts at the sill and head corners. Fold the remaining flashing tape into the opening over the primary jamb. Then use the J-roller to remove any air pockets.



- 18** Apply a second layer of flashing tape to cover the window fin, buck edge and primary jamb overlapping at least 1". Use the J-roller to remove any air pockets.

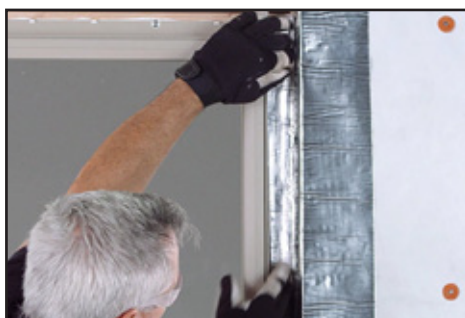

- 19** Apply head flashing with pre-cut relief cuts at the head and side jamb corners. Fold the remaining flashing into the opening over the primary head jamb and use the J-roller to remove any air pockets.



- 20** Apply a second layer of head flashing to cover the window fin, buck edge, and primary head flashing, overlapping the primary jamb flashing a minimum of 1". Use the J-roller to remove any air pockets.



- 21** Pull down the top flap and tape both 45 degree corners with flashing tape or WRB joint tape. Seal the WRB over the header with sealant or flashing tape.



- 22** From the interior apply OSI® QUAD® foam into the gap between the window and the framing at the head, side, and sill jambs. This must be a continuous seal with no visible shims.



- 23** Allow 25 to 35 minutes for foam to cure and trim off the excess with a sharp knife.



2016 Henkel Corporation All Rights Reserved.

This job aid is intended for OSI Certified installers and contains critical steps for the use of the Quad Window & Door System and does not cover the entire sequence to activate the Limited Warranty. For more information and to become an OSI Certified Installer visit OSITough.com/training