



TECHNICAL DATA SHEET

RUBBERIZED ASPHALT WINDOW FLASHING TAPE

ASPHALT FLASH

FOR USE WITH QUAD
WINDOW & DOOR SYSTEM



Description: OSI® Asphalt Flash flexible flashing is a rubberized asphalt backed, self-adhering 20-mil membrane. This membrane is a laminate consisting of a 2 mil high density polypropylene film and a removable release sheet that has been developed specifically for the QUAD® Window and Door System. It is efficient, easy to use and provides excellent moisture and air infiltration protection around windows. It can also be used to seal doors and similar gaps and openings. Asphalt Flash can be easily applied in horizontal and vertical applications and will adhere to most common building substrates including vinyl, wood and concrete.

Available As:

Item #	Size	Color
1866180	4 in x 100 ft (10 cm x 30.5 m)	Black
1866211	6 in x 100 ft (15 cm x 30.5 m)	Black
1020002	9 in x 100 ft (22.8 cm x 30.5 m)	Black

Features & Benefits:

- For Use with OSI® QUAD® Window & Door System
- Highly Durable, Resists Damage & Tearing
- Integrates Window into the Opening
- Self-adhering Tape Makes it Easy to Install, Inspect & Repair

Recommended For:

Asphalt Flash is part of the QUAD® Window & Door System and is used to provide an air and vapor barrier around window and door flanges and joints and cracks in exterior wall assemblies. It is also useful for other above grade wall flashing applications.

For Best Results:

- Do not use in areas where flashing will be subject to continuous exposure to sunlight or to temperatures in excess of 149°F (65°C)
- Do not leave Asphalt Flash exposed for longer than 30 days
- Do not apply over flexible PVC
- Concrete, masonry and some exterior gypsum substrates may require priming for best results
- Do not apply flashing or primer to damp, frosty or contaminated surfaces

Coverage:

- A 4 in x 100 ft roll provides 33.3 ft² (3.05 m²) of coverage
- A 6 in x 100 ft provides 50 ft² (4.58 m²) of coverage
- A 9 in x 100 ft provides 75 ft² (6.95 m²) of coverage



TECHNICAL DATA SHEET

Typical Physical Properties:

Color:	Black
Appearance:	Rubberized asphalt
Total Thickness:	20 mils
Shelf Life:	24 months from date of manufacture (unopened)

Typical Application Properties:

Application Temperature:	40°F (4°C) to 125°F (52°C)
--------------------------	----------------------------

Typical Performance Properties:

Service Temperature:	Do not apply where temperatures >149°F (65°C) are expected	
Tensile Strength:	709 psi	ASTM D412
Lap Adhesion:	4.5 lb/in width	ASTM D1876 modified
Puncture Resistant:	27 lbs (min)	ASTM E154
Peel Strength:	4.5 lb/in width	ASTM D903
Specifications:	**Conforms to ASTM E2112 Standard Practice for Installation of Exterior Windows, Doors and Skylights, Sec. 5.13 and Appendix X1.2 – Flexible Flashing	

**The WINTeQ™ System uses similar practices and principle as ASTM E2112 Standard Practice for Installation of Exterior Windows, Doors and Skylights. ASTM E2112 is intended to provide technical guidance to organizations that are developing training programs for installers of fenestration units. The majority of fenestration units and materials used to install them are certified as meeting specified performance characteristics. The WINTeQ™ System products have been tested in accordance with the relevant specifications required for performance under both ASTM and AAMA guidelines. The specifications for each product are listed on each components individual technical data sheet.

Directions:

Tools Typically Required: Utility knife

Safety Precautions: Wear gloves and wash hands after use.

Application Procedures:

METHOD A: SILL PAN METHOD

Step 1: Cut Weather Resistant Barrier

Cut and remove weather resistant barrier (WRB) from rough opening using the new OSI QUAD Window & Door System modified "O" method. The modified "O" cut employs the technique of cutting the WRB back 2" beyond the jambs to allow for direct and permanent seal of the window flange to the exterior sheathing. Cut top portion of WRB to create flap, then fold up and temporarily tape above head (Figure 1).

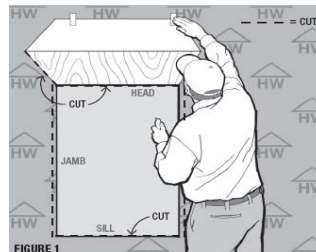

Figure 1

Step 2: Install Sill Plan Flashing

2.1.1 Remove backing from pre-cut OSI QUAD Window & Door System corner guard and position a guard at each jamb and sill intersection so that ½ of the guard is covering the flat sill and jamb and the remaining half is pulled out over the exterior sheathing (Figure 2).



TECHNICAL DATA SHEET

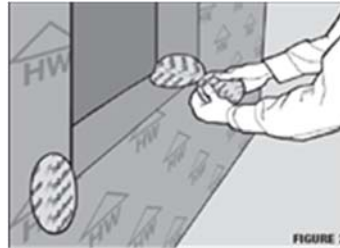

Figure 2

Cutting and Applying Flashing

The following flashing cut formulas should be used to determine the length of each strip of flashing for each window.

Tip: It is best to pre-cut flashing to save time during installation process. Using the rough opening dimensions and the formula listed will ensure appropriate length. Be sure to label the cut pieces for easy identification during installation.

FLASHING LENGTHS AND CUT FORMULAS	
Sill Flashing	= $RO^W + 2''$
Jamb Flashing	= $RO^H + (2 \times \text{flashing width}) - 1''$
Head Flashing	= $RO^W + (2 \times \text{flashing width}) + 2''$
legend	
RO	= rough opening
RO ^H	= rough opening vertical (height)
RO ^W	= rough opening horizontal (width)

- 2.2.1 Pre-cut a length of 6" Asphalt Flash 12" longer than the sill rough opening. Apply pre-cut flashing by removing the release backing and carefully starting 6" up and 3" in rough opening (or minimum depth of window frame) on one jamb side. Continue to apply the flashing across sill and up opposite side jamb. Once the flashing is attached to the sill and jambs, make a cut in each corner to allow the remaining unattached flashing to fold out and over the exterior sheathing (Figure 3).



Figure 3

- 2.3.1 Roll smooth to ensure air bubbles are removed and flashing is adhered to the sill and exterior sheathing.

Step 3: Install Window

- 3.1.1 Shim sill and jambs to allow for a minimum 1/4" gap (1/2" gap optimal) between rough opening and window. Some window manufacturers require the placement of shims and OSI recommends placement of shim on the sill to allow for a minimum 1/4" gap. When called for by the window manufacturer, shims must be left in place. When used as a spacer they can be removed after the window has been mechanically anchored.

For left in place shims, apply a bead of QUAD Max across where shim will mount. Embed shim in sealant and then apply a second bead of sealant over shim. This will ensure a complete seal around the shim.

- 3.2.1 Apply a continuous bead of QUAD Max to the interior side of the nailing fin, on jambs and head flanges and an intermittent bead on the sill flange (Figure 4).



Figure 4

- 3.3.1 Install window into opening within 10 minutes by placing window sill on rough opening sill shims and tilt in header (Figure 5). Press firmly into place.



Figure 5

- 3.4.1 Place a mechanical fastener on one side of the nailing flange in the upper part of the flange. Do not drive the fastener all the way in this time.
- 3.5.1 Check for level, plumb and true, shim as necessary to achieve.
- 3.6.1 Ensure window is square and operates smoothly.
- 3.7.1 Continue to mechanically fasten the window in place beginning at the opposite side of the first fastener. Make sure window remains plumb, true and square.
- 3.8.1 Do not over drive fastener heads.

Step 4: Install Jamb Flashing

Asphalt Flash should be installed to both sides of the jamb following the listed steps.

- 4.1.1 Jamb flashing should extend above the head and below sill of the rough opening equal to the width of the flashing less $\frac{1}{2}$ ".
- 4.2.1 Install jamb flashing so that the flashing covers the nailing flange and is tight to window frame edge (Figure 6).

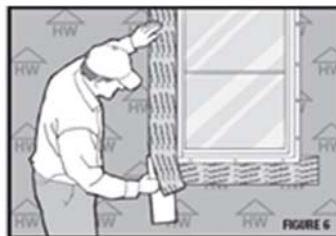

Figure 6

- 4.3.1 Roll smooth to ensure air bubbles are removed and intimate contact is made between substrates (Figure 7).



TECHNICAL DATA SHEET

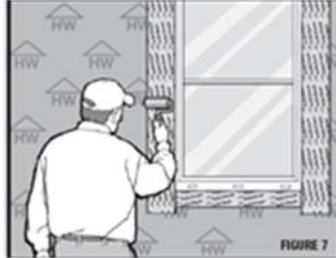

Figure 7

Step 5: Install Head Flashing

Install Asphalt Flash to the head condition of the window flange as described in the listed steps.

- 5.1.1 Head flashing should extend beyond jamb flashing by 1" on both sides (Figure 9). Apply head flashing under WRB flap created in Step 1.

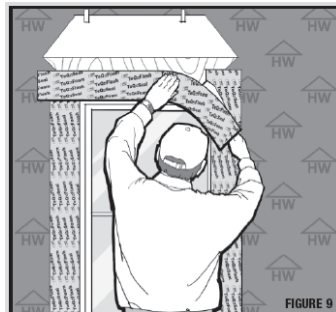

Figure 9

- 5.2.1 Install head flashing so that the Asphalt Flash covers the nailing flange and is tight to the window frame edge.
5.3.1 Remove tape that holds flap created in Step 1 and pull flap down over head flashing (Figure 10).

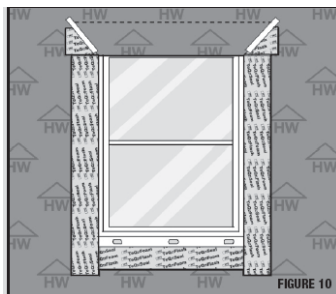

Figure 10

- 5.4.1 Apply tape over diagonal cut made in the WRB made using the modified "O" method.

Step 6: Install Interior Insulation

Interior insulation is an integral part of the QUAD Window & Door System. Once window has been fully installed following Steps 1 through 5, QUAD Foam can be applied to the interior side of the window between the rough opening and the window frame. QUAD Foam has been specifically designed for window and door applications and should be installed using the listed steps (6.1.1 – 6.8.1).

- 6.1.1 Safety first, always wear gloves, eye protection and proper work clothes when using QUAD Foam.
6.2.1 Attach applicator gun to QUAD Foam can.
6.3.1 Starting at the header cavity on one side of the window, insert gun nozzle into gap (Figure 11).



TECHNICAL DATA SHEET



Figure 11

- 6.4.1 Pull trigger on applicator gun and begin to apply foam while simultaneously moving applicator along gap.
- 6.5.1 Apply foam to a depth of approximately $\frac{1}{2}$ of the depth of the cavity between the window frame and the rough opening (Figure 12).

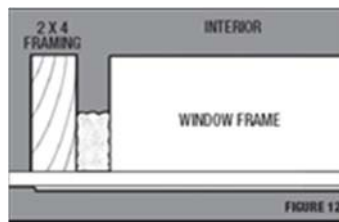

Figure 12

- 6.6.1 Continue application of foam down each jamb gap and into the sill gap.
- 6.7.1 Trim off excess foam with sharp knife once cured (approximately 10 minutes).
- 6.8.1 Clean up spills and foam from unwanted areas immediately with acetone. Cured foam is difficult to remove and must be sanded or cut away.

METHOD B: BARRIER METHOD

(Window Installation based on AAMA 2400 Method "A1")

Step 1: Cut Weather Resistant Barrier

Cut and remove weather resistant barrier (WRB) from rough opening using OSI QUAD Window & Door System modified "O" method. Cut top portion of WRB to create flap, then fold up and temporarily tape above head condition (Figure 1).



Figure 1

Step 2: Install Sill Flashing

- 2.1.1 Apply Asphalt Flash to sill condition by removing the release backing and placing the top edge level to the rough opening (Figure 2). Sill flashing should extend past rough opening on each side equal to the approximate width of Asphalt Flash (i.e. 9" flashing should extend beyond jambs on each side by 9").



Figure 2



TECHNICAL DATA SHEET

Cutting and Applying Flashing

The following flashing cut formulas (Figure 3) should be used to determine the length of each strip of flashing for each window. The ASTM standard requires a minimum width of 9" for flexible flashing. Wider flashing materials (i.e. 12") may be used.

Tip: It is best to pre-cut flashing to save time during installation process. Using the rough opening dimensions and the formula listed will ensure appropriate length. Be sure to label the cut pieces for easy identification during installation.

FLASHING LENGTHS AND CUT FORMULAS	
Sill Flashing	= $RO^W + 2"$
Jamb Flashing	= $RO^H + (2 \times \text{flashing width}) - 1"$
Head Flashing	= $RO^W + (2 \times \text{flashing width}) + 2"$
legend	
RO	= rough opening
RO ^H	= rough opening vertical (height)
RO ^W	= rough opening horizontal (width)

Figure 3

2.2.1 Roll smooth to ensure air bubbles are removed and intimate contact is made between substrates (Figure 4).

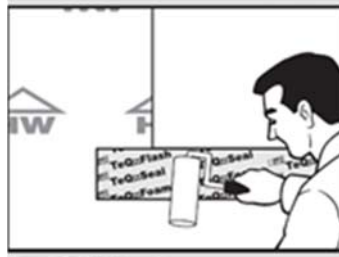

Figure 4

Step 3: Install Window

3.1.1 Shim sill and jambs to allow for a minimum 1/4" gap (1/2" gap optimal) between rough opening and window. Some window manufacturers require the placement of shims and OSI QUAD Window & Door System recommends placement of shim on the sill to allow for a minimum 1/4" gap. When called for by the window manufacturer, shims must be left in place. When used as a spacer they can be removed after the window has been mechanically anchored.

For left in place shims, apply a bead of QUAD Max across area where shim will mount. Embed shim in sealant and then apply a second bead of sealant over shim. This will ensure a complete seal around the shim.

3.2.1 Apply a continuous bead of QUAD Max to the interior side of the mounting flange. Apply QUAD Max so that it covers over nailing slots on flange when provided (Figure 5).



Figure 5

3.3.1 Install window into opening within 10 minutes by placing window sill on rough opening sill shims and tilt in header (Figure 6). Press firmly into place.



TECHNICAL DATA SHEET

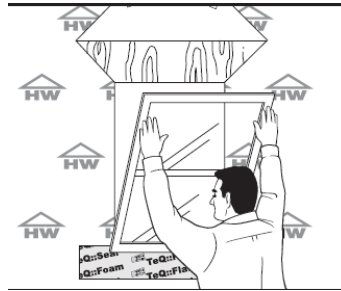

Figure 6

Place a mechanical fastener on one side of the nailing flange in the upper part of the flange. Do not drive the fastener all the way in at this time.

3.5.1 Check for level, plumb and true, shim as necessary to achieve.

3.6.1 Ensure window is square and operates smoothly.

3.7.1 Continue to mechanically fasten the window in place beginning at the opposite side of the first fastener. Make sure the window remains plumb, true and square.

3.8.1 Do not over drive fastener heads.

Step 4: Install Jamb Flashing

Asphalt Flash should be installed to both sides of the jamb following the listed steps.

4.1.1 Jamb flashing should extend above the head and below the sill of the rough opening equal to the width of the flashing less $\frac{1}{2}$ " (i.e. 9" flashing should extend beyond rough opening of head and sill by $8\frac{1}{2}$ ". Refer to Figure 3 for cut formulas.

4.2.1 Install jamb flashing so that the flashing covers the nailing flange and is tight to window frame edge (Figure 7).



Figure 7

4.3.1 Roll smooth to ensure air bubbles are removed and intimate contact is made between substrates (Figure 8).

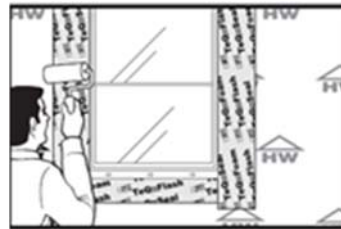

Figure 8

Step 5: Install head flashing

Install Asphalt Flash to the head condition of the window flange as described in the listed steps.

5.1.1 Head flashing should extend beyond jamb flashing by 1" on both sides (Figure 9). Apply head flashing under WRB flap created in Step 1.



Figure 9



TECHNICAL DATA SHEET

- 5.2.1 Install head flashing so that Asphalt Flash covers the nailing flange and is tight to the window frame edge.
- 5.3.1 Remove tape that holds flap created in Step 1 and pull flap down over head flashing (Figure 10).

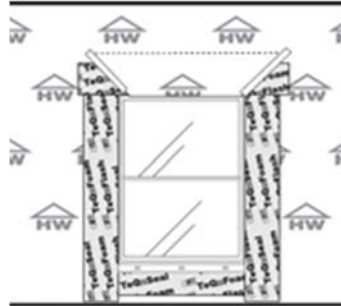

Figure 10

- 5.4.1 Apply tape over diagonal cut made in the WRB made using the modified “O” method.

Step 6: Install Interior Insulation

Interior insulation is an integral part of the OSI QUAD Window & Door System. Once window has been fully installed following Steps 1 through 5, QUAD Foam can be applied to the interior side of the window between the rough opening and the window frame. QUAD Foam has been specifically designed for window and door applications and should be installed using the listed steps (6.1.1 to 6.8.1).

- 6.1.2 Safety first, always wear gloves, eye protection and proper work clothes when using QUAD Foam
- 6.2.2 Attach applicator gun to QUAD Foam can.
- 6.3.2 Starting at the header cavity on one side of the window, insert gun nozzle into gap (Figure 11).



Figure 11

- 6.4.2 Pull trigger on applicator gun and begin to apply foam while simultaneously moving applicator along gap.
- 6.5.2 Apply foam to a depth of approximately ½ of the depth of the cavity between the window frame and the rough opening (Figure 12).

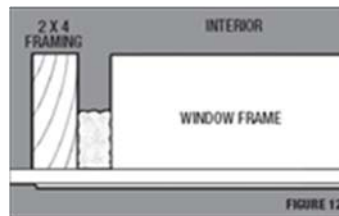

Figure 12

- 6.6.2 Continue application of foam down each jamb gap and into the sill gap.
- 6.7.2 Trim off excess foam with sharp knife once cured (approximately 10 minutes).
- 6.8.2 Clean up spills and foam from unwanted areas immediately with acetone. Cured foam is difficult to remove and must be sanded or cut away.

Storage & Disposal:

Protect from excessive heat or cold. Store away from open flames and sparks. Do not store in direct sunlight or other harmful environmental conditions. Protect cartons from rain.



TECHNICAL DATA SHEET

Label Precautions:

CAUTION! MAY CAUSE SKIN AND EYE IRRITATION. Contains asphalt and aromatic oil. Avoid contact with skin and clothing. Avoid rubbing eyes while using product. Wear oil impermeable gloves. Wash hands after using. **FIRST AID:** For eye contact flush with water for 15 minutes. Call a physician if irritation develops and persists. **WARNING:** Contains chemicals known to the State of California to cause cancer. For professional use only. **KEEP OUT OF REACH OF CHILDREN.**

Refer to the Safety Data Sheet (SDS) for further information.

Limited Warranty:

This product is warranted to be free from defects in materials when used as directed. Henkel's sole obligation shall be, at its option, to replace or refund the purchase price of product proven to be defective. Henkel makes no other warranty, express or implied, including warranties of MERCHANTABILITY and FITNESS FOR A PARTICULAR PURPOSE and will not be liable for consequential or incidental damages. This limited warranty gives you specific legal rights, which vary from state to state. Henkel may be contacted at 1.800.624.7767 M-F 9:00 am to 4:00 pm ET for warranty assistance.

Disclaimer:

The information and recommendations contained herein are based on our research and are believed to be accurate, but no warranty, express or implied, is made or should be inferred. Purchasers should test the products to determine acceptable quality and suitability for their own intended use. Nothing contained herein shall be construed to imply the nonexistence of any relevant patents or to constitute a permission, inducement or recommendation to practice any invention covered by any patent, without authority from the owner of the patent.



OSI Tougher than the Elements. For Professional Use Only. The Battle will be Fierce.

OSI works side by side with residential builders, contractors and remodeling professionals who use our products everyday on their jobsites. OSI combines this deep understanding with the sophisticated global innovation and manufacturing excellence of Henkel to make the world's best professional-grade caulks, sealants and adhesives.

1-800-624-7767 – Mon-Fri - 9:00a – 4:00p ET

www.ositough.com



OSI Brand is part of the Henkel family of brands. Founded in 1876, Henkel is a global leader in the consumer and industrial businesses. Henkel operates worldwide with leading brands and technologies in three business areas: Laundry & Home Care, Beauty Care and Adhesive Technologies.

Henkel Corporation - Professional & Consumer Adhesives Headquarters - Rocky Hill, CT 06067

www.henkelna.com

Revision Date: 07/31/2014 Supercedes: 05/15/2012 Post Date: 07/31/2014