

LOCTITE® INSTRUCTIONS FOR 97220 FEEDLINE KIT

- ☞ For viscous products, a feedtube adapter with a 9.5 mm product feedline is available.
- ! When mounting the feedtube adapter, the product feedline must be cut off. The contact of anaerobic products with the metal of a knife or other objects can cause curing and lead to malfunction of the dispensing valve. For anaerobic products, the dispensing valve must therefore be previously cleaned.

- Cut off the product hose evenly with a knife, cutters or hose cutter approximately 13 cm from dispensing valve.
- Slide the black caps on the 6.3 mm and 9.5 mm hoses.

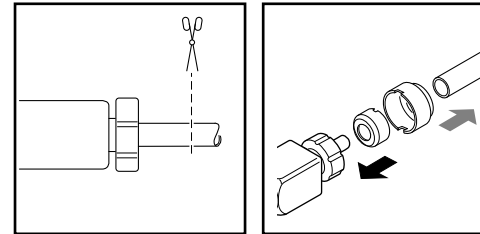

- Firmly insert the 6.3 mm and 9.5 mm product hoses into the adapter. Press on the black caps as protection against unintentional loosening of the feedline connections.

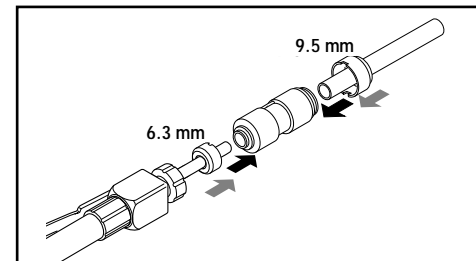

- Replace the 6.3 mm Reservoir Tank connector with the 9.5 mm connector.
- Prime the product feedline and adjust the dispensing quantity according to the appropriate instruction manual.

 **Loctite Corporation**
Loctite (Ireland) Ltd.
Tallaght Business Park
Whitestown
Tallaght, Dublin 24, Ireland
North American Group
1001 Trout Brook Crossing
Rocky Hill, CT USA 06067